



CRUISERS YACHTS

# 60 CANTIUS



# 60 CANTIUS

When you step aboard the 60 Cantius, the possibilities are endless. Luxurious and comfortable, powerful and elegant, the 60 Cantius is versatile at every turn. With spacious quarters above and below deck, you can spend more time on the water than ever before. Along with the standard amenities, the 60 Cantius boasts a style and charm that cannot be matched.



## Specifications

	IMPERIAL	METRIC
LOA	59' 10"	18,24 m
BEAM	16'	4,9 m
BRIDGE CLEARANCE (TOP OF MAST LIGHT)	16' 9"	5,1 m
DRAFT – FULL LOAD	48"	1,27 m
FUEL CAPACITY	647 gal	2449 L
WATER CAPACITY	149 gal	564 L
WASTE CAPACITY	100 gal	379 L
WEIGHT – DIESEL (DRY)	53,000 lbs	24040 kg

\*\*\* Weight, Bridge Clearance, Draft subject to change \*\*\*

\*\*\* Consumable liquids may be less than max capacity \*\*\*

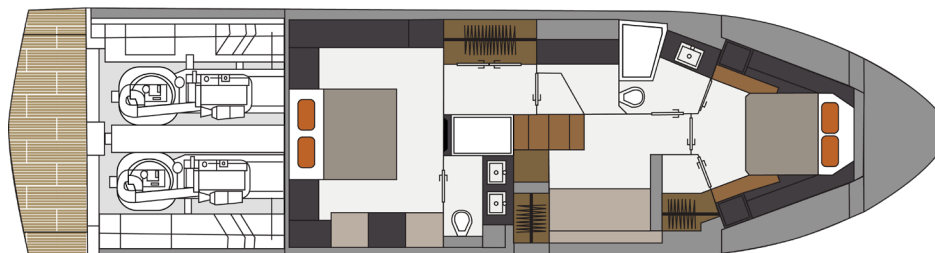
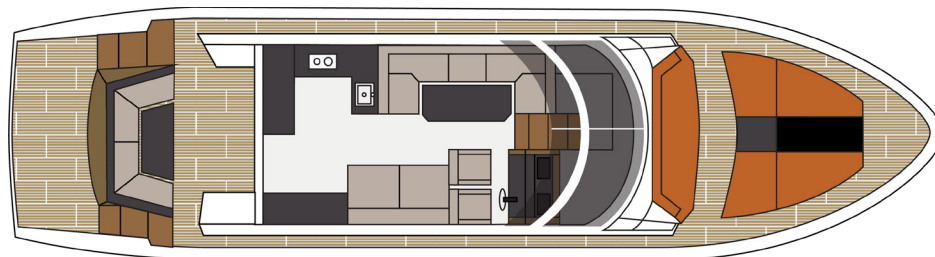





**BOW LOUNGE** – Designed with comfort and luxury in mind, and refusing to compromise on either, the bow is arguably the best seat on the ship. Ideal for morning coffees and conversation, the bow lounge features a comfy crescent lounge area as well as two reclining sun pads.

**HELM** – Be comfortable and in-control with an ultra-plush captains chair and companion seat. With cutting-edge digital screens and instruments, as well as a completely clear, unobstructed view of the trip ahead, you'll have everything you need to ensure smooth sailing.



**UPPER SALON** – Surrounded by windows, your guests can enjoy a meal in the formal dining area paired with a plush, U-shaped settee or relax with a cocktail on the sofa. The retractable window opens the space to the rear deck for passing refreshments and sharing conversation.



**GALLEY** – The galley is equipped with all the tools you'll need to host your soirée, such as a convection oven, microwave, wine steward, bottle storage, ice maker, dishwasher, and more. Separated from the cockpit by full-length sliding glass doors, the galley is the perfect way to keep your guest entertained.



**COCKPIT** – Dual entry from the swim platform is outfitted with a U-shaped seating area with optional bar stools facing the galley. The wet bar is located on the port side.



**MASTER STATEROOM** – Complete with a king-size bed, this roomy cabin has a café table with two built in seats perfect for pouring over the morning news or enjoying fresh poured coffee. Other amenities include a walk in closet and a master head with double shower and his and hers wash basins.



**VIP STATEROOM** – This elegant space offers maximum sound and distance privacy while providing comfort. The VIP Stateroom features a queen berth, large head with a separate shower stall and generous counter space, and also a walk-in closet – something rarely seen in the second stateroom, even on far larger boats.



**THIRD STATEROOM** – The 60's third stateroom is always filled with natural light, and comes equipped with plush and roomy bunk beds and a flat-screen TV.





# 60

# CANTIUS

## Standard Features

## Engine Option

Volvo D11, 950IPS, DPS, EVC, 725 HP

### HULL COLOR

White

### INTERIOR COLOR

Sail White

### WEATHER COVERS

Bar Stool Covers  
Bow Seat Covers  
Chaise Lounge Covers  
Cockpit Seat Covers  
Windshield Sunscreen  
Colors – White or Black

### COCKPIT SEATING COLOR

Pearl White

### INTERIOR WOOD

Ebony Oak

### INSTRUMENTS

Compass  
Glass Cockpit  
Electronics w/ Digital Switching  
Helm Seat w/ Captain and Companion  
Horn  
Instrumentation Integrated w/ Electronics  
Raymarine Sonar, Dual 16" GS165  
Displays w/Remote, 4 kW HD Open  
Radar, Autopilot & VHF Radio  
Remote Spotlight  
Volvo DPS (Digital Positioning System)  
Volvo IPS Diesel  
Volvo IPS Joystick

### MECHANICAL

AC/DC Panel w/ Voltmeters  
ACR – Auto Charging Relay  
Air Conditioning  
60 lbs Anchor w/ 203' 13mm Chain  
Auto Stabilizing System, 110-230 VAC  
Battery Charging System & Monitor  
Battery Parallel Switch  
Bilge Coating, White  
Bilge Pumps (3), w/ High Water Alarms  
Engine Room Blowers  
Bonding Systems w/ Transom Zinc  
Bronze Seacocks and Thru Hulls  
On All Underwater Fittings  
Dockside Power – Single 50 Amp Service  
Fire Extinguisher, Automatic  
Fire Extinguishers (4)  
Fuel Transfer Pump  
Generator – 21.5 kW Onan Diesel Genset  
Generator – Remote Start / Stop  
Ground Fault Interrupt Outlet  
LED Lights  
Master Panel, AC w/ Voltmeters  
Seawater Strainers  
Swim Platform w/ Hydraulic Lift  
Tilt Steering Wheel  
Trim Tabs

### MAIN DECK

Aft Cockpit Seating, U-Shaped  
Anchor Roller  
Bar Stools, Transom  
Boarding Gate, Transom (2)  
Bottom Paint, Anti-Fouling  
Bow Rail, Welded Stainless Steel  
Cockpit Shower  
Dockside Water Hookup  
Dual Side Deck Walkways  
Electric Cockpit Grill  
Fiberglass Cockpit, Self Draining  
Foredeck Bench Seating  
Foredeck Chaise Lounge  
Foredeck Cooler  
Gunwale Molding, Stainless Steel  
Hardware, Deck Cleats 10"  
Hatch – Bow w/ Screen and Shade  
Helm Seat, Electric, Sail White  
Performance Textiles Bow Shade  
Storage, Beneath Seating  
Storage, Side Deck Walkways, Midship (2)  
Swim Platform w/ Boarding Ladder  
Windlass  
Windshield Wipers w/ Washdown  
Woven Mat Cockpit Flooring

### GALLEY / SALON

Aft Sureshade, Motorized  
Bottle Storage  
Cockpit to Salon Entry – Single Level  
Door, Bi-Fold w/ Powered Window  
Flooring – Amtico  
Fridge, Port Galley  
Freezer w/ Ice Maker, Starboard Galley  
Galley Countertop – Solid Surface  
Galley Exhaust Fan  
Microwave / Convection Oven  
Opening Sunroof, Motorized  
Salon Seating, U-Shaped Dinette  
w/Opposed Bench Seating  
Salon TV and Stereo w/ HDMI Outlet

### GALLEY / SALON CONTINUED

Salon Under Seat Storage  
Stainless Steel Sink w/ Designer Faucet  
Stove, Electric, 2 Burner  
Windows – Opening, Salon w/ Blinds

### ACCOMMODATIONS LEVEL

Carpet  
Day Head, w/Private Access to VIP,  
Stall Shower  
Dryer  
Master Head w/ Dual Vanity  
Master Shower  
Master Stateroom, Clothes Locker  
w/ Bi-Fold Doors  
Master Stateroom, Drawer Storage, STBD  
Master Stateroom, Electric Blinds  
Master Stateroom, King Size Berth  
Master Stateroom, Settee, Port  
Master Stateroom, TV and Stereo w/ HDMI  
Third Stateroom, Flooring, Amtico, Mocha Oak  
Third Stateroom w/ Slide Out Double  
Third Stateroom TV, 24", Ebony Oak  
VIP Stateroom, Hatch w/ Skylight & Blind  
VIP Stateroom, TV and Stereo w/ HDMI  
VIP Stateroom, Queen Size Berth  
VIP Stateroom, Walk-In Clothes Locker  
Washer  
Windows – Heads, Opening  
Windows – Master, Large Fixed Glass  
w/ Opening  
Windows – VIP, Large Fixed Glass  
w/ Opening

For more information on the 60 Cantius  
or to locate a dealer, please visit  
**[cruisersyachts.com](http://cruisersyachts.com)**