



CRUISERS YACHTS

54 CANTIUS



54 CANTIUS

Awe-inspiring and free-spirited, the 54 Cantius was envisioned for those who live joyously spontaneous lives on and off the water. Three luxurious staterooms, refined appointments and ingenious features all exemplify perfection. But it is the manner in which the 54 Cantius seamlessly integrates living spaces with gentle breezes and starlit nights that truly evokes passion.



Specifications

	IMPERIAL	METRIC
LOA	54' 7"	16,6 m
BEAM	15' 6"	4,7 m
BRIDGE CLEARANCE (TOP OF MAST LIGHT)	16' 5"	5 m
DRAFT – FULL LOAD	48.5"	1,23 m
FUEL CAPACITY	500 gal	1892 L
WATER CAPACITY	150 gal	568 L
WASTE CAPACITY	70 gal	265 L
WEIGHT – DIESEL (DRY)	43,600 lbs	19776 kg

*** Weight, Bridge Clearance, Draft subject to change ***

*** Consumable liquids may be less than max capacity ***

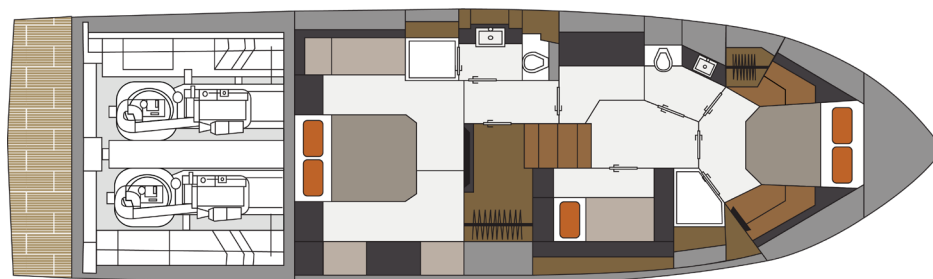
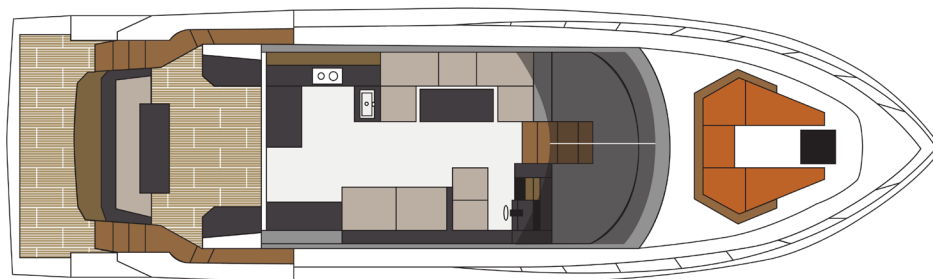



BOW LOUNGE – Bask in the warm sun and enjoy a front-seat view from the pop-up lounge chairs of the vast horizon in the 54 Cantius bow lounge. The chairs can be adjusted to your preference and lay flat when not in use.

COCKPIT – Dual entry from the swim platform is outfitted with a U-shaped seating area with optional bar stools facing the galley. The wet bar is located on the port side.



UPPER SALON – Windows provide 360° views from the open-concept galley, dinette and helm. Retractable windows in the galley open aft to merge interior and exterior spaces, creating endless possibilities for unparalleled entertaining. Rest assured, your guests' time aboard will not soon be forgotten.



GALLEY – Cleverly positioned aft to provide optimum entertaining functionality, the galley allows host and guests alike to be at the center of attention. Everyone's favorite feature is sure to be the retractable window that opens the galley to the rear deck for passing refreshments and sharing conversation.



HELM – Digital throttles, joystick controlling and a panel with plenty of space for your choice in devices will have you feeling completely in control of this beautiful new yacht.



MASTER STATEROOM – The master stateroom onboard the 54 Cantius is a stylishly serene and unusually spacious full-beam retreat. Surrounding the walk-around island berth you will find a café table tucked between two built-in seats, plus built-in nightstands and vanity.



VIP STATEROOM – With a walk-around queen berth, generous storage and panoramic windows, the forward stateroom found in the 54 Cantius ensures blissful days and tranquil nights for all. The accompanying head is thoughtfully split with separate head and shower starboard and port.



THIRD STATEROOM OPTION – The spacious dual bunk beds provide plenty of space for overnight guests. A large TV, and additional storage make this space a welcome addition.





54 CANTIUS

Standard Features

Engine Options

Volvo D8, 800IPS, DPS, EVC, 600 HP
Volvo D11, 950IPS, DPS, EVC, 725 HP

HULL COLOR

White

INTERIOR COLOR

Sail White

WEATHER COVERS

Bow Seat, Chaise Lounge & Cockpit Seat
Windshield Sun Screen
Black

COCKPIT SEATING COLOR

Pearl White

INTERIOR WOOD

Ebony Oak

INSTRUMENTS

Compass
Glass Cockpit
Helm Seat w/ Companion
Horn
Instrumentation
Remote Spotlight
Volvo DPS (Digital Positioning System)
Volvo IPS Diesel
Volvo IPS Joystick

MECHANICAL

AC/DC Panel w/ Voltmeters
ACR – Auto Charging Relay
Air Conditioning
50 lbs Anchor w/ 200' 3/8 HS Chain
Auto Stabilizing System, 110-230 VAC
Battery Charging System & Monitor
Battery Parallel Switch
Bilge Coating, White
Bilge Pumps (3), w/ High Water Alarms
Bonding Systems w/ Transom Zinc
Bronze Seacocks and Thru Hulls
On All Underwater Fittings
Dockside Power – Single 50 Amp Service
Engine Room Blowers
Fire Extinguisher, Automatic
Fire Extinguishers (4)
Generator – 17 kW Onan Diesel Genset
Generator – Remote Start / Stop
Ground Fault Interrupt Outlet
LED Lights
Master Panel, AC w/ Voltmeters
Seawater Strainers
Swim Platform w/ Hydraulic Lift
Tilt Steering Wheel
Trim Tabs

MAIN DECK

Anchor Roller
Boarding Gate – Transom (2) and Side Deck Walkways (2)
Bottom Paint, Anti-Fouling
Bow Rail, Welded Stainless Steel
Bow Shade
Cockpit Lines Storage (Underneath Cockpit Seats)
Cockpit Shower
Dockside Water Hookup
Fiberglass Cockpit, Self Draining
Gunwale Molding, Stainless Steel
Hardware, Deck Cleats 10"
Hatch – Bow w/ Screen and Shade
Swim Platform w/ Boarding Ladder
U-Shaped Aft Cockpit Seating
Windlass
Windshield Wipers w/ Washdown
Woven Mat Cockpit Flooring

GALLEY / SALON

Cockpit to Salon Entry – Single Level
Door, Bi-Fold w/ Powered Window
Exhaust Fan, Galley
Flooring, Amtico
Freezer / Ice Maker, Starboard Galley
Fridge, Port Galley
Galley Countertop, Solid Surface
Ice Maker, Starboard Galley
Microwave / Convection Oven
Opening Salon Windows w/ Blinds
Opening Sunroof, Motorized
Panoramic View Windows
Salon Seating, U-Shaped Dinette w/Opposed Bench Seating
Salon TV and Stereo w/ HDMI Outlet
Stainless Steel Sink w/ Designer Faucet
Stove, Electric, 2 Burner

ACCOMMODATIONS LEVEL

Carpet
Day Head w/ Private VIP Stateroom Access w/ Seperate Adjoining Shower
Flooring, Amtico, Lower Salon, Ebony Oak
Master Stateroom, Clothes Locker
Master Stateroom, Drawer Storage
Master Stateroom, Head w/ Seperate Adjoining Shower
Master Stateroom, Seating Area
Master Stateroom, TV & Stereo w/ HDMI
Master Stateroom, Queen Size Berth
Third Stateroom
Third Stateroom TV, 24", Mocha Oak
VIP Stateroom TV, 28", Mocha Oak
VIP Stateroom, Queen Size Berth
Windows – Heads, Opening
Windows – Master, Large Fixed Glass w/ Opening
Windows – VIP, Large Fixed Glass w/ Opening

For more information on the 54 Cantius
or to locate a dealer, please visit
cruisersyachts.com