



CRUISERS YACHTS

# 50 CANTIUS





# 50 CANTIUS

It's the perfect fit. The 50 Cantius marries luxury and function to accommodate you and your guest in unparalleled comfort. The 50 Cantius matches your lifestyle whether you want to escape for weekend adventures or extended trips. Aboard, you'll find every amenity you could ask for at sea, including refined staterooms, sophisticated heads and plenty of space for entertainment.



## Specifications

	IMPERIAL	METRIC
LOA	49' 5"	15,06 m
BEAM	15'	4,57 m
BRIDGE CLEARANCE (TOP OF MAST LIGHT)	15' 7"	4,75 m
DRAFT – FULL LOAD	47"	1,19 m
FUEL CAPACITY	450 gal	1703 L
WATER CAPACITY	111 gal	420 L
WASTE CAPACITY	70 gal	265 L
WEIGHT – DIESEL (DRY)	36,000 lbs	16329 kg

\*\*\* Weight, Bridge Clearance, Draft subject to change \*\*\*

\*\*\* Consumable liquids may be less than max capacity \*\*\*

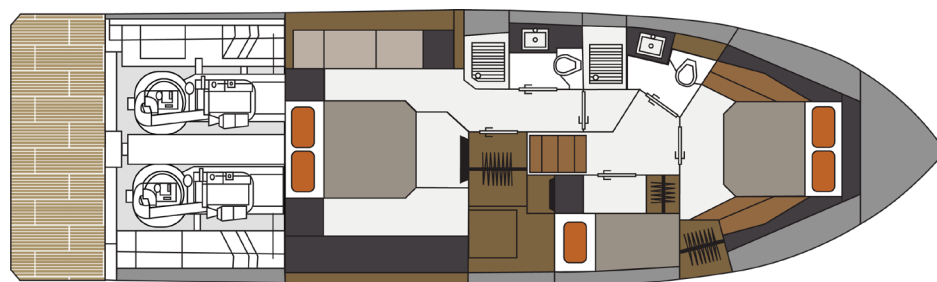
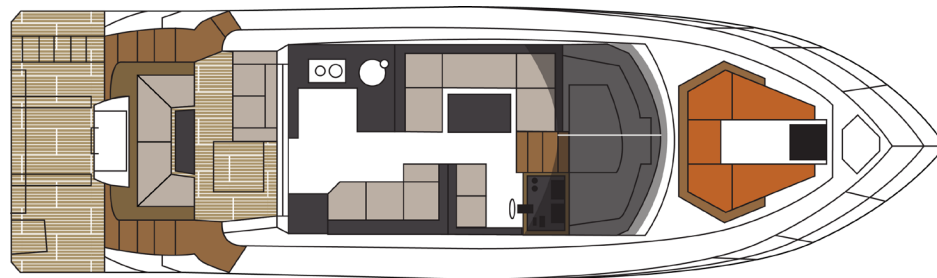



**BOW LOUNGE** – The 50 Cantius seems to have endless space. Take full advantage of all this yacht has to offer from bow to stern. Catch up on much needed conversations or escape the day-to-day with sunshine and beautiful views from the bow of this striking yacht.

**HELM** – The first-class design includes double seats and come equipped with flip-up bolsters and arm rests. Digital throttles, joystick controlling and a panel with plenty of space for your choice in devices will have you feeling completely in control.



**UPPER SALON** – Panorama windows provide 360° views from the open-concept galley, dinette and helm. Retractable windows in the galley open aft to merge interior and exterior spaces, creating endless possibilities for unparalleled entertaining. Rest assured, your guests' time aboard will not soon be forgotten.



**COCKPIT** – The cockpit includes large U-shaped seating with optional aft facing seating to accommodate any activity. The grill is located on the transom, accessed via the swim platform, to maximize usable space.



**GALLEY** – The retractable window opens the space to the rear deck for passing refreshments and sharing conversation. The galley is ingeniously positioned aft to provide optimum entertaining functionality.



**MASTER STATEROOM** – Surrounding the walk-around island berth you will find a café table tucked between two built-in seats, plus built-in nightstands and vanity. Additional hidden storage gives you all the room you need for life's necessities.



**VIP STATEROOM** – The Forward Stateroom has a walk-around queen berth, generous storage and panoramic windows that provide the kind of waterfront views most can only dream about. The accompanying head is thoughtfully split with separate head and shower starboard and port.



**THIRD STATEROOM** – Natural light illuminates the spacious dual bunk beds which provide plenty of space for overnight guests. A large TV and additional storage are provided.







# 50 CANTIUS

## Standard Features

### Engine Option

VV,D8,700 IPS,DPS,EVC,550 HP

#### HULL COLOR

White

#### INTERIOR COLOR

Sail White

#### WEATHER COVERS

Bow Seat Covers  
Cockpit Seat Covers  
Windshield Sun Screen  
Colors – White or Black

#### COCKPIT SEATING COLOR

Pearl White

#### INTERIOR WOOD

Ebony Oak

#### INSTRUMENTS

Compass  
Glass Cockpit  
Helm Seat w/ Companion  
Horn  
Instrumentation  
Remote Spotlight  
Volvo DPS (Digital Positioning System)  
Volvo IPS Diesel  
Volvo IPS Joystick

#### MECHANICAL

ACR – Auto Charging Relay  
Air Conditioning  
50 lbs Anchor w/ 200' 3/8 HS Chain  
Auto Stabilizing System, 110-230 VAC  
Battery Charging System & Monitor  
Battery Parallel Switch  
Bilge Coating, White  
Bilge Pumps (3), w/ High Water Alarms  
Bonding Systems w/ Transom Zinc  
Bronze Seacocks and Thru Hulls  
On All Underwater Fittings  
Cental Vacuum System, 120V  
Dockside Power – Single 50 Amp Service  
Engine Room Blowers  
Fire Extinguisher, Automatic  
Fire Extinguishers (4)  
Generator – 17 kW Onan Diesel Genset  
Generator – Remote Start / Stop  
Ground Fault Interrupt Outlet  
LED Lights  
Master Panel, AC w/ Voltmeters  
Seawater Strainers  
Swim Platform w/ Hydraulic Lift  
Tilt Steering Wheel  
Trim Tabs

#### MAIN DECK

Anchor, 50 lbs  
Boarding Gate – Transom (2) and  
Side Deck Walkways (2)  
Bottom Paint, Anti-Fouling  
Bow Shade  
Bow Rail, Welded Stainless Steel  
Cockpit Shower  
Dockside Water Hookup  
Fiberglass Cockpit, Self Draining  
Grill, Electric, Transom  
Gunwale Molding, Stainless Steel  
Hardware, Deck Cleats 10”  
Hatch – Bow w/ Screen and Shade  
Storage – Cockpit, Power Seat  
Swim Platform w/ Boarding Ladder  
U-Shaped Aft Cockpit Seating  
Windlass  
Windshield Wipers w/ Washdown  
Woven Mat Cockpit Flooring

#### GALLEY / SALON

Cockpit to Salon Entry – Single Level  
Door, Bi-Fold w/ Powered Window  
Exhaust Fan – Galley  
Flooring – Amtico  
Galley Countertop – Solid Surface  
Microwave / Convection Oven  
Refrigerator / Freezer, Starboard Galley  
Drawer Fridge, Port Galley  
Opening Salon Windows w/ Blinds  
Opening Sunroof, Motorized  
Salon Seating, U-Shaped Dinette  
w/Opposed Bench Seating  
Salon TV and Stereo w/ HDMI Outlet  
Stainless Steel Sink  
Stove, Electric, 2 Burner

#### ACCOMMODATIONS LEVEL

Carpet  
Day Head w/ Private VIP Stateroom  
Access  
w/ Seperate Adjoining Shower  
Master Stateroom, Clothes Locker  
Master Stateroom, Drawer Storage  
Master Stateroom, Head w/ Seperate  
Adjoining Shower  
Master Stateroom, Seating Area  
Master Stateroom, Queen Size Berth  
Master Stateroom TV, 24”  
Third Stateroom  
VIP Stateroom, Clothes Locker  
VIP Stateroom, Queen Size Berth  
VIP Stateroom TV, 28”  
Windows – Heads, Opening  
Windows – Master, Large Fixed Glass  
w/ Opening  
Windows – VIP, Large Fixed Glass  
w/ Opening

For more information on the 50 Cantius  
or to locate a dealer, please visit  
**[cruisersyachts.com](http://cruisersyachts.com)**