



CRUISERS YACHTS

34 GLS OB



34 GLS OB

The GLS series continues its powerful, entertainment-centered yacht line with the 34 GLS. The 34 GLS's cockpit features two cockpit L-shaped seating areas. The portside seating has an adjustable backrest while the larger starboard side seating converts into a large, aft facing sunpad. The lower salon features an aft stateroom, a dinette that converts into a berth, fridge, and microwave.



Specifications

	IMPERIAL	METRIC
LOA – OUTBOARDS DOWN	35' 10"	10,9 m
LOA – OUTBOARDS UP	38' 4"	11,7 m
BEAM	11' 10"	3,6 m
BRIDGE CLEARANCE (TOP OF MAST LIGHT)	12' 11"	3,94 m
DRAFT DOWN	42"	1,1 m
DRAFT UP	26"	0,7 m
FUEL CAPACITY	217 gal	821 L
WATER CAPACITY	25 gal	94,63 L
WASTE CAPACITY	25 gal	94,63 L
WEIGHT – DRY	15,800 lbs	7167 kg

*** Weight, Bridge Clearance, Draft subject to change ***

*** Consumable liquids may be less than max capacity ***

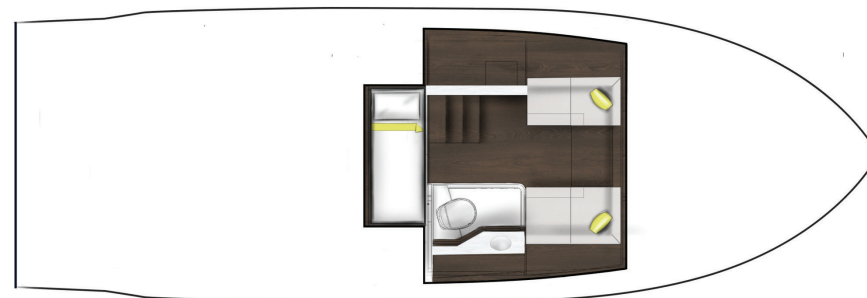
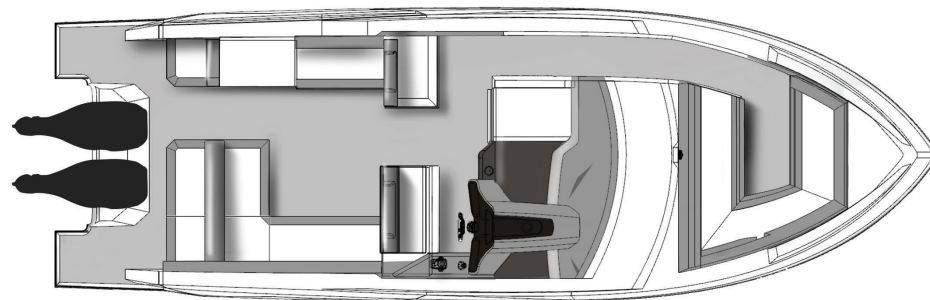



BOW SEATING - The bow seating features a table that easily converts into a sunpad, Rockford Fosgate speakers, and multiple cupholders. An optional foredeck shade keeps your guests nice and cool.

HELM - The helm aboard the 34 GLS is impeccably designed with Simrad electronics and joystick piloting. Underneath the bolster helm chair is storage or optional ice maker.



COCKPIT - The 34 GLS's cockpit features two cockpit L-shaped seating areas. The portside seating has an adjustable backrest that when flipped in the aft facing position, makes a companion seat. On the larger starboard side, the aft backrest can be flipped into the forward position to create a large aft-facing sunpad. There is also a personal, aft-facing seat on the port side.



GALLEY - The galley features a fiberglass inlay sink, fridge, grill, and storage. The galley is located in the cockpit for easy flow of conversation to guest sitting on the L-shaped seating.



TWIN MERCURY VERADOS - The joystick piloting allows you to navigate with ease at the top speed of 46 mph or cruise at 37 mph with the 600 hp option.



AFT STATEROOM - Need to rest for the night? The aft stateroom aboard the 34 GLS features a custom sized berth, and personal reading lights.



LOWER SALON - The lower salon features a dinette that converts into a spacious berth. The lower galley is complete with a fridge, microwave, and TV.



HEAD - The 34 GLS head features a sink, toilet, and standing shower. Storage hidden behind the mirror and underneath the sink allows you to tuck away personal items.





34 GLS OB

Standard Features

Engine Options

GAS ENGINES

TWIN MERCURY VERADO 300 (600 HP)
 TWIN MERCURY VERADO 350 (700 HP)
 TWIN MERCURY VERADO 400 (800 HP)
 TWIN MERCURY VERADO 450R (900 HP)

HULL COLOR

White

WEATHER COVERS

Bow & Cockpit Seat
 Black

SEATING COLOR

White and Gray

WOOD COLOR

Ebony Oak

INSTRUMENTS

Horn
 Joystick Piloting

MECHANICAL

AC/DC Panel w/ Voltmeters
 Anchor
 Battery Charger
 Battery Parallel Switch
 Bilge Coating, White
 Bilge Pumps (3), w/High Water Alarms
 Bonding Systems w/Transom Zinc
 Bronze Seacocks and Thru Hulls
 on all Underwater Fittings
 Dockside Power – Dual 30 Amp Service
 Engine Room Blowers
 Fire Extinguisher, Automatic
 Fire Extinguishers, Handheld (3)
 Fuel Overflow Recovery System
 Ground Fault Interrupt Outlets
 Hydraulic Trim Tabs
 LED Lighting
 Seawater Strainers
 Stainless Steel Propellers
 Tilt Steering Wheel

MAIN DECK

Walk-Thru Windshield
 Cockpit Shower
 Deck Cleats
 Dockside Water Hookup
 Fiberglass Cockpit, Self Draining
 Gunwale Molding, Stainless Steel
 Hardtop, White
 Helm Seat Storage
 Storage (2), L-Shaped Seating
 Transom Boarding Gate
 Welded Stainless Bow Rails
 Windlass
 Windshield Wiper
 Wireless Phone Charging Pad

WETBAR

Sink, Set in Fiberglass
 Solid Surface Countertop
 Storage Under Wet Bar

ACCOMMODATIONS LEVEL

Aft Berth
 Amtico Flooring
 Head Sink
 Electric Head w/ Holding Tank
 Interior Storage
 Microwave
 Mirrors w/ Storage, Head
 Opening Port Hole Above Lower Salon
 Entry Stairs
 Opening Port Hole in Head
 Refrigerator
 Shower in Head
 Starboard Window

For more information on the 34 GLS OB
 or to locate a dealer, please visit
cruisersyachts.com